

LINE F. WELDED UPRIGHT ELECTR. BOARDS

Line for welded upright for electric switchboards

54002 1 **DECOILERS**
Decoilers from 2 up to 30 tonnes.

55001 2 **STRAIGHTENER USEFUL WIDTH 300 mm**
Straightener w. useful width 300 mm max. thickness 4 mm and 7 straightening rolls.

10002 3 **FEEDER WITH ROLLS**
Electronic feeder with rolls L series.

254 4 **MECHANICAL PRESS 80 t**

194 5 **PUNCHING DIE WITH EXCLUSIONS**

240-50-A 6 **ROLL FORMING LINE PME50 TYPE F. FORMING**
18 forming stations

329 7 **WELDING HEAD**

318 8 **TUBE COOLING PLANT**

28004 9 **FLYING CUTTING SAW**

169 10 **UNLOADING BENCH WITH CHUTE**

251-252 11 **CONTROL DESK W. ELECTRICAL INSTALLATION**

24001 12 **SERIES OF FORMING ROLLS**

60 13 **HIGH FREQUENCY WELDING UNIT**



General view of the machine



Finished product



Decoiler, heading and welding bench, press



51101B

Line for welded upright for electric switchboards

PM sas
Via Montegrappa, 109
30030 Salzano (Ve) Italy
Tel +39 0415745047
Fax +39 0415745058
www.pm-eng.info
pm@pm-eng.info

LINE F. WELDED UPRIGHT ELECTR. BOARDS

Line for welded upright for electric switchboards



Production line for uprights and profiles for electric boards punched from strip, formed (with profiling), welded and cut to measure. Welding is with high frequency (as option with laser). The cut is with cutting saw with slow disk (as option hydraulic cut).

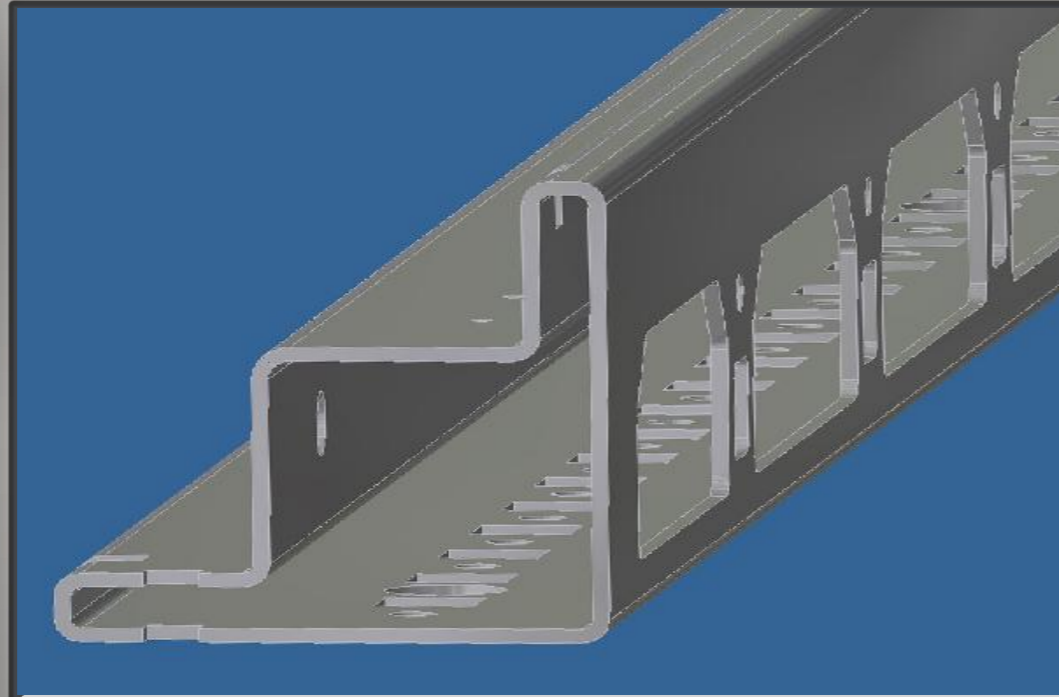

Three-dimensional representation of a product



Detail of roll forming line

Maximum width	500	mm
Material for upright: galvanized		
Material thickness:	1.5	mm
Decoiler capacity	2	t
Line speed	-8	m/min.
Line direction: from right to left		
Line colour:	5015	RAL



Finished product



Finished product



Flying saw and unloading bench



Control desk

51101B

