

- 54002G    1 **DECOILER 5 t**

---

- 55001D    2 **STRAIGHTENER FEEDER WITH ROLLS 600**  
*Straightener feeder with 9 rolls, useful width 600 mm*

---

- 3N        3 **MECHANICAL PUNCHING PRESS**  
*150 t - 80 blows/min*

---

- 194A     4 **CUTTING DIE WITH EXCLUSIONS**  
*Punching die with automatic punch exclusions*

---

- 240-80-144    5 **ROLL FORMING LINE PME TYPE**  
*Shaft Ø 90 mm - useful width 700 mm - n° 20 passages*

---

- 6B2       6 **FIX CUTTING PRESS**

---

- 169       7 **UNLOADING BENCH WITH CHUTE**

---

- 251-252    8 **CONTROL DESK W. ELECTRICAL INSTALLATION**

---

- 24001A    9 **SERIES OF ROLLS**  
*Series of forming rolls for uprights and diagonals*

---

- 295       10 **HYDRAULIC POWER PACK**  
*Hydraulic power pack with hydraulic plant*

---

- 12E       11 **DIE FOR COMBINABLE CONNECTORS**  
*Die for combinable connectors for the two models*

---

- 13C       12 **SERIES OF CASSETTES W ROLLS F. BEAM A**

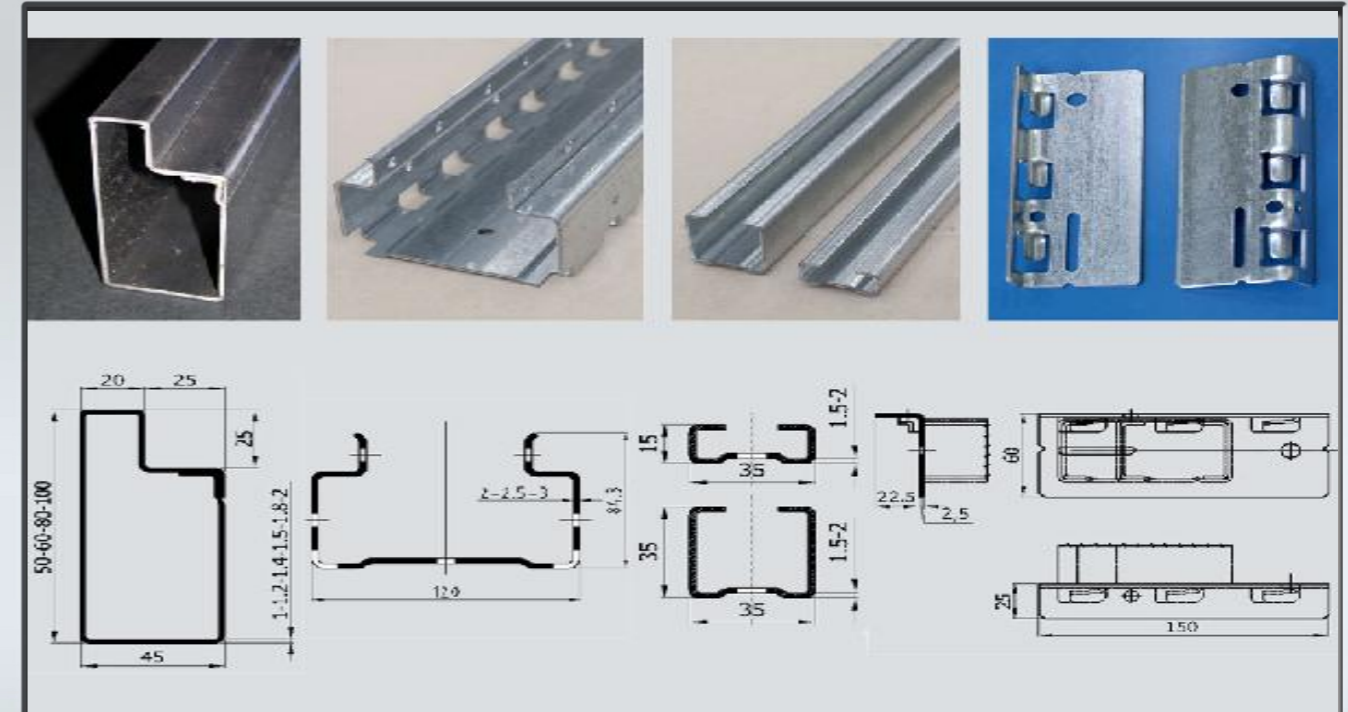

Products



Decoiler

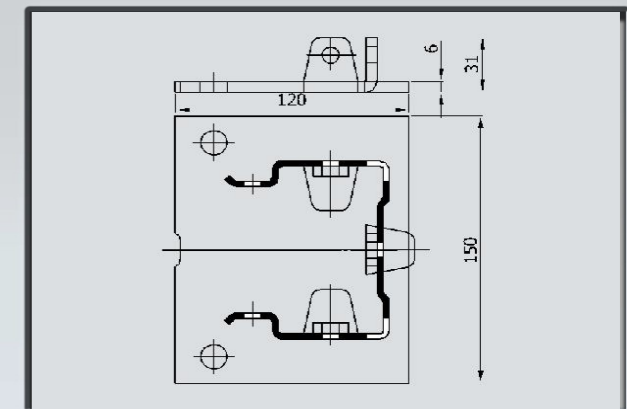

Assembly schema feet-upright



50501Q

PM sas  
Via Montegrappa, 109  
30030 Salzano (Ve) Italy  
Tel +39 0415745047  
Fax +39 0415745058  
www.pm-eng.info  
pm@pm-eng.info

## PALLET RACKING SHELVING I TYPE



Line making possible the production of pallet racking shelving complete with tools for uprights 80-100-120, diagonals 35-15, beam with seat 50-60-80-100, connectors, foot.



View of the line

|                                  |             |        |
|----------------------------------|-------------|--------|
| Material:galvanized              |             |        |
| Max. material thickness :        | 1.5-2-2.5-3 | mm     |
| Decoiler capacity                | 5           | t      |
| Length max.                      | 12          | mm     |
| Line speed                       | -8-9        | m/min. |
| Useful width roll forming line   | 700         | mm     |
| Line direction: to be determined |             |        |
| Uprights of                      | 80-100-120  | mm     |
| Installed power:                 | 150         | Kw     |
| Absorbed power                   | 120         | KW     |
| Air consumption:                 | 200         | NI/1   |

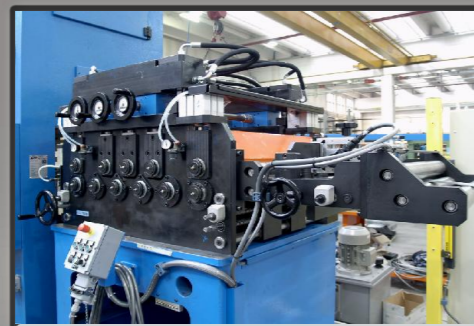

Straightener feeder



Detail of die on press



Roll forming line



Cutting die and unloading bench

50501Q

